

CRYSTALAUDIO

BT-01



On-ear Headphones



User Manual

Overview

Folding Mechanism

On/Off
Activation/
Deactivation

Microphone
Built-in HD Mic

LED light
Indication

micro USB
Charging port

Aux In
Auxiliary input

Control button
Tel. Calls & Music

Pair button
Bluetooth pairing

Control button
Volume Up/Down

User
Manual



micro USB
charging cable

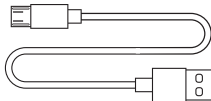

Audio cable
3.5mm minijack

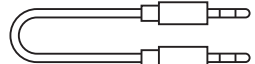

Charge it

- Use the micro USB cable which is **included** in the package of the headphones.

- **A different micro USB cable might not be able to charge** correctly (or even not at all) the battery of the headphones.

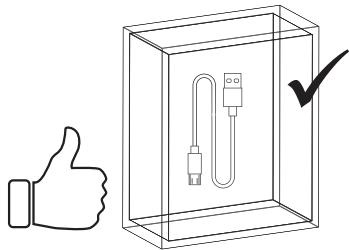

Connect:

- the **micro USB plug** into the headphone's USB port.
- the **USB plug** into any compatible USB device.

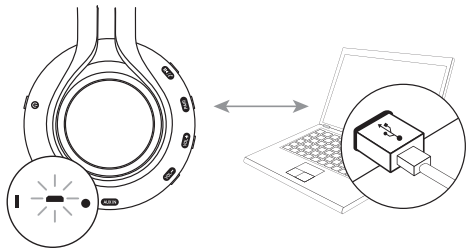

red

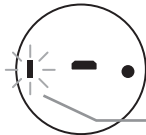

blue

- While battery is **charging** the indication light is red.

- When battery has been **fully charged** the light turns blue.



A full charge of the battery takes approx. **1.5 hours**

! The headphones are automatically deactivated during charging process.

Use it



Music



Calls

Short press:
Play/Pause



Short press:
Answer/End call

Long press:
Reject call

Double click:
Redial last outgoing call

Short press:
Increase volume

Long press:
Next track

VOL+

Short press:
Increase volume

Short press:
Decrease volume

Long press:
Previous track

VOL-

Short press:
Decrease volume

Connect it

1

- Push the On/Off button to the left or to the right to **activate** (or deactivate) the headphones.



- Once turned on, the headphones enter automatically into **Pairing mode**

2

- The indication light is flashing **red-blue, alternately**.

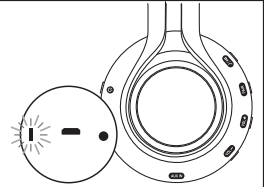

3

- **Activate** Bluetooth mode on your BT device.
- **Search** for available devices and select **CRYSTAL AUDIO BT-01**.



4

- The indication light turns **blue, permanently**.
- Connection is successful.

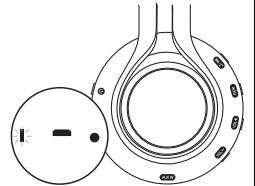

- Please turn the headphones off when not in use in order to preserve battery life.
- The headphones will connect to the last paired device automatically as soon as you turn them on.
- The headphones will be automatically turned off if they are not connected to a device within 3 minutes.

WARRANTY

The product comes with a 1-year warranty starting from the purchase date. Warranty is valid only with the original proof of purchase (receipt or invoice). This warranty covers only the repair or replacement of the device and it is effective only in Greece.

DECLARATION OF CONFORMITY

Radio equipment and telecommunications terminal equipment, Directive 2014/53/EU



Crystal Audio hereby declares that the product, BT-01 Wireless Headphones, is in conformity with provisions of the Directive 2014/53/EU. The complete text of the Declaration of conformity can be found on the following webpage: www.CrystalAudio.com

Technical Specifications

Bluetooth® Version:	v5.0
Battery Capacity:	300mAh
Charge Time:	≈1.5 hours
Talk/Playback Time:	up to 18 hours
AUX Cable Length:	120cm
USB Cable Length:	50cm
Drivers:	40mm
Sensitivity:	100dB
Impedance:	64Ω
Freq. Response:	20Hz-20KHz
Weight:	160g

WARNING

- Using the headphones at a high volume for an extended period might lead to hearing damage.
- This product is not a toy. Keep out of reach of children.
- This product is not waterproof. It should be kept away from liquids and places of extreme humidity, rain, snow etc.
- Low battery may lead to "Poor" or "Lost" Bluetooth connection.
- Do not overcharge the battery of the device.
- Avoid exposing the product to excessive heat sources such as fire, candles, radiators, direct sunlight etc.
- This product should not be treated as household waste. Please hand over to the applicable collection point for the recycling of electronic equipment.

Designed in Europe by Crystal Audio.
Assembled in China with the highest quality standards.

The Bluetooth® word mark and logos are registered trademarks owned by Bluetooth SIG Inc. and any use of such marks by Crystal Audio is under license.



www.CrystalAudio.com